

## INSTALLATION

### 1. INSTALL HYDRAULIC BRAKE BOOSTER

- (a) Install a new gasket onto the hydraulic brake booster.
- (b) Install the hydraulic brake booster with the 4 nuts.  
**Torque: 14 N\*m (145 kgf\*cm, 10 ft.\*lbf)**

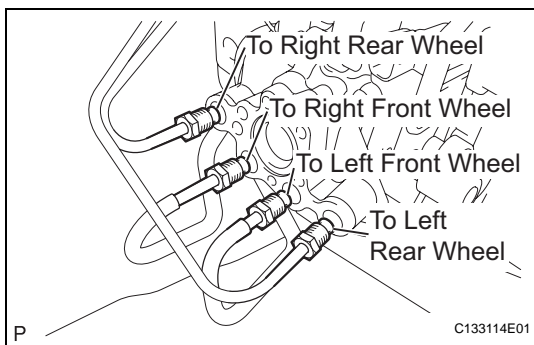
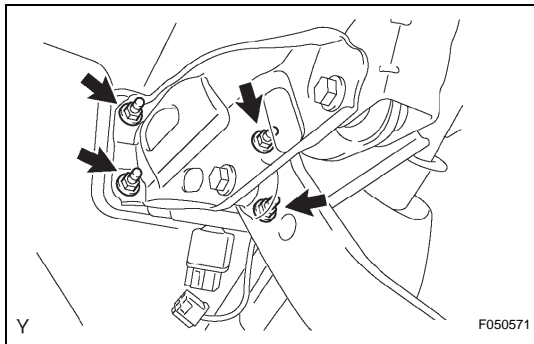

- (c) Using SST, connect the 4 brake tubes to the correct positions on the hydraulic brake booster, as shown in the illustration.

**SST 09023-00101**

**Torque: for use without SST**

**15 N\*m (155 kgf\*cm, 11 ft.\*lbf)**

**for use with SST**

**14 N\*m (143 kgf\*cm, 10 ft.\*lbf)**

**HINT:**

- Use a torque wrench with a fulcrum length of 300 mm (11.81 in.).
- This torque value is effective when SST is parallel to the torque wrench.

- (d) Connect the 3 connectors.

### 2. INSTALL MASTER CYLINDER PUSH ROD CLEVIS (See page BR-14)

### 3. CONNECT CABLE TO NEGATIVE BATTERY TERMINAL

**Torque: 3.9 N\*m (40 kgf\*cm, 35 in.\*lbf)**

### 4. FILL RESERVOIR WITH BRAKE FLUID (See page BR-5)

### 5. BLEED BRAKE BOOSTER WITH ACCUMULATOR PUMP ASSEMBLY (See page BR-5)

### 6. BLEED BRAKE LINE (See page BR-5)

### 7. BLEED MASTER CYLINDER SOLENOID (See page BR-6)

### 8. CHECK FLUID LEVEL IN RESERVOIR (See page BR-7)

### 9. CHECK FOR BRAKE FLUID LEAKAGE

### 10. INSPECT AND ADJUST BRAKE PEDAL (See page BR-10)

### 11. INSTALL INSTRUMENT PANEL LOWER FINISH PANEL SUB-ASSEMBLY (See page IP-29)

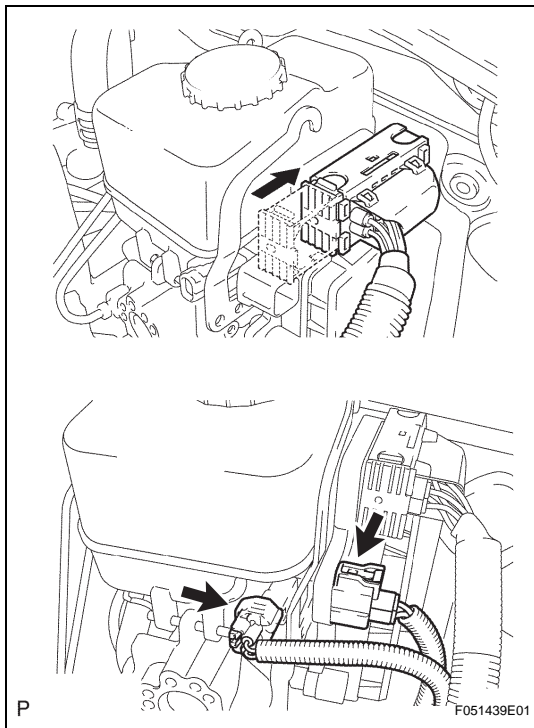

12. CONNECT HOOD LOCK CONTROL LEVER SUB-ASSEMBLY (See page [IP-30](#))
13. INSTALL INSTRUMENT PANEL NO. 1 REGISTER ASSEMBLY (See page [IP-30](#))
14. INSTALL FRONT DOOR OPENING TRIM WEATHERSTRIP (See page [IP-33](#))
15. INSTALL COWL SIDE TRIM BOARD (See page [IR-45](#))
16. INSTALL FOOTREST CLIP (See page [IR-2](#))
17. INSTALL FRONT FLOOR FOOTREST (See page [IR-2](#))
18. INSTALL FRONT DOOR SCUFF PLATE (See page [IR-45](#))
19. INSPECT BRAKE MASTER CYLINDER OPERATION (See page [BR-20](#))

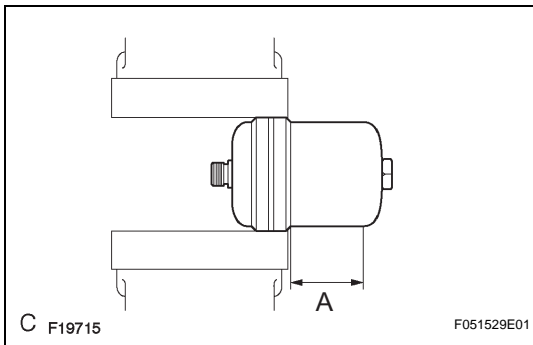

## DISPOSAL

1. DISPOSE OF BRAKE BOOSTER ACCUMULATOR ASSEMBLY
  - (a) Place the brake booster accumulator in a vise and cover it with a cloth.
  - (b) Slowly cut a hole in area A on the brake booster accumulator as shown in the illustration. And discharge the gas and liquid inside.
 

**NOTICE:**

    - **As gas may spray out, cover the brake booster accumulator with a cloth when performing the operation.**
    - **Work slowly and do not cut the hole too quickly or suddenly.**
    - **Wear protective glasses during the operation.**
  - (c) When the outer body of the brake booster accumulator is cut, gas and liquid discharge.
 

**HINT:**

    - The gas is colorless, odorless and nonpoisonous nitrogen gas.
    - The liquid is brake fluid.